

# T0605 Series

## SPECIFICATIONS

Item	T0605N
1. Rated Voltage (V)	DC 5
2. Rated Current/Phase (mA/RMS)	83
3. Coil DC Resistance (Ohm)	60±10%
4. Step Angle (Degree)	18
5. Drive Mode	Constant Voltage
6. Excitation Method	2-2 Phase excitation(Bipolar driving)
7. Insulation Class	Class E
8. Pull-out Torque (g-cm/pps)	0.72/500
9. Pull-in Torque (g-cm/pps)	0.55/500
10. Max. Pull-out Pulse Rate (pps)	4800
11. Max. Pull-in Pulse Rate (pps)	1540

## CHARACTERISTICS

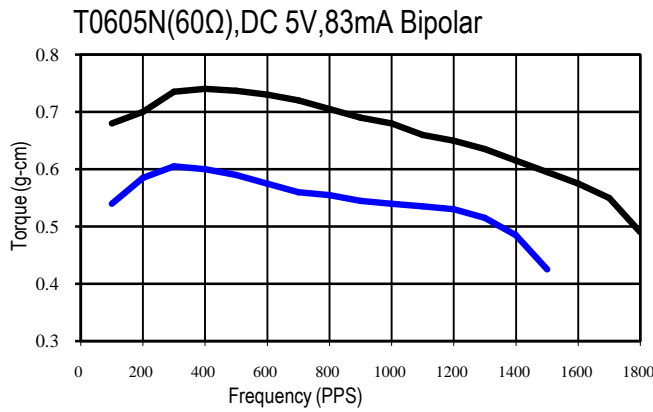

## DIMENSIONS

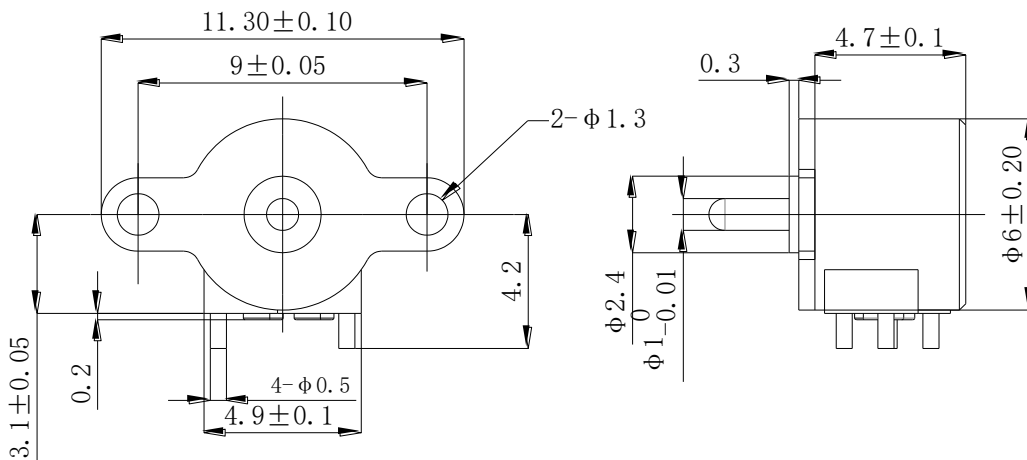

Unit: mm  
General Tolerance:  $\pm 0.1$