

# T0505GN Series

## SPECIFICATIONS

Item	T0505GN
Rated Voltage	DC 5V
Rated Current/Phase	260mA(RMS)
Coil DC Resistance	14Ω±10%
Gear Ratio	1:120
Step Angle	0.15°/step
Drive Method	Constant Voltage
Excitation Method	2-2 Phase excitation(Bipolar driving)
Insulation Class	Class E insulation
Pull-out Torque	45 g-cm/2400pps
Pull-in Torque	40 g-cm/2400pps
Max. Pull-out Pulse Rate	3000pps
Max. Pull-in Pulse Rate	2000pps

## CHARACTERISTICS

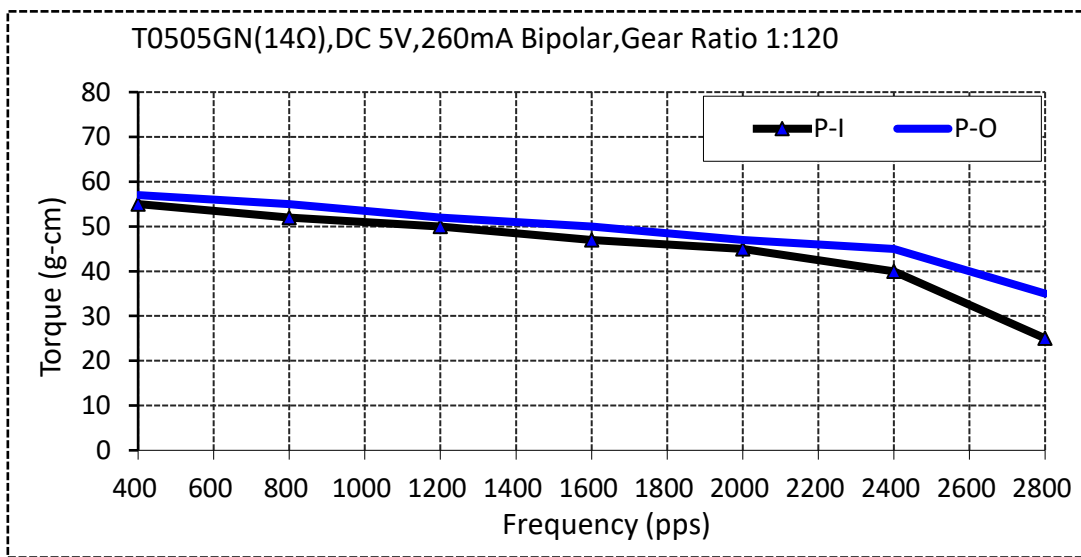

## DIMENSIONS

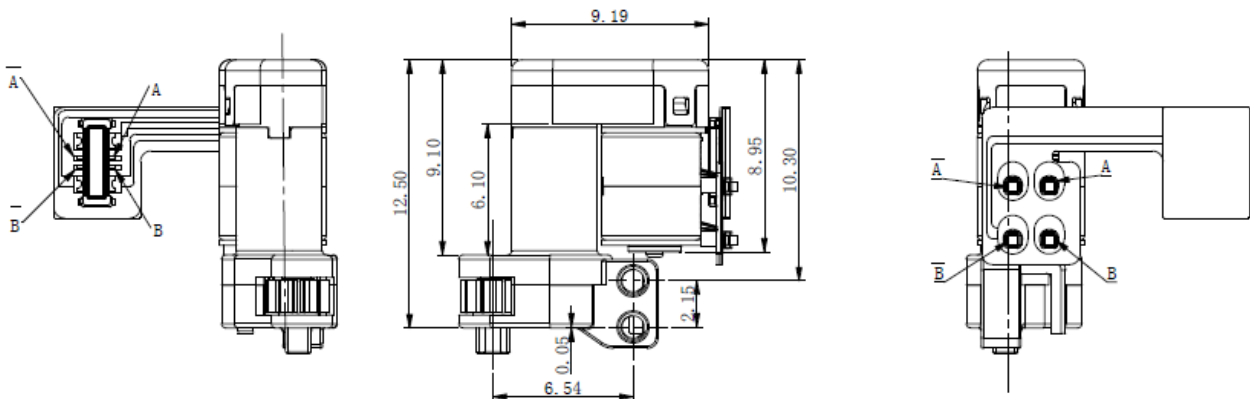

Unit : mm

General tolerance: ±0.1